

## HELIO SHADE HV80 - MOTORISED EXTERNAL VENETIAN

80mm curved blades, with rounded edges for strength

Choose from a range of popular European RAL colours

Rolled aluminium slat with baked enamel paint finish

Galvanised Steel head-rail 58 x 56mm

All pull cords are UV resistant polyester

Optional pelmet - dimensions: Depth = 120mm. Height = custom sized to stack height of blades

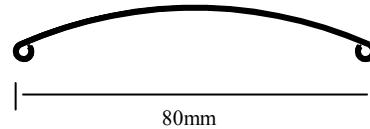

Guiding Options:

18x23mm aluminium channels with noise reducing lining

2mm s/steel cables, with insulation

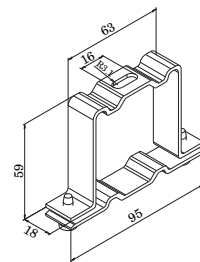

Standard head-box  
mount bracket

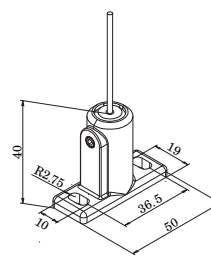

Bottom fix bracket for  
cable guiding

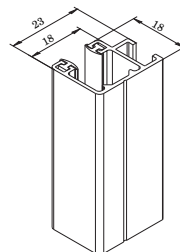

Side Channel

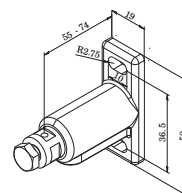

Wall mount bracket for  
channel / cables

